

# Bike Rack Installation Instructions

## Cora Bike Rack - ASR-E Adult eScooter Charging Rack

This instruction sheet is to be used for ASR-E electric charging racks

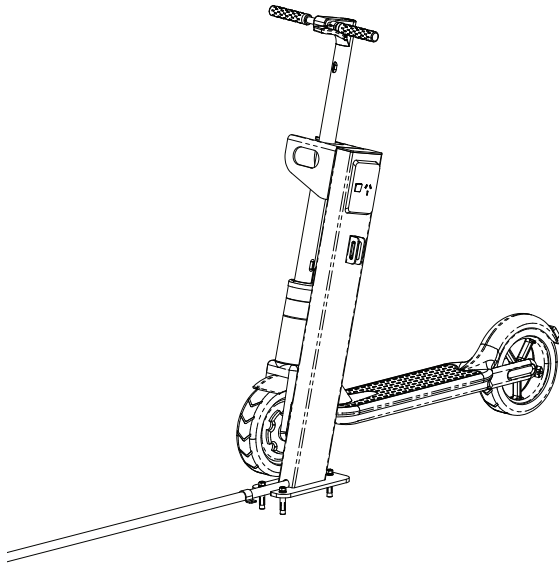

Cora - Bike Rack ASR-E

### ELECTRICAL INSTALLATION WARNING:

The ASR-E rack requires the installation of electrical components and connection to a mains power source.

**ASR-E should only be installed by a licensed / certified / qualified electrical contractor in accordance with all relevant Australian regulations and specifications.**

**Cora does not warrant or assume liability regarding issues of compliance for the ASR-E rack installation; assembly of electrical components; or connection to a mains power source.**

These instructions are provided for installation guidance only and do not construe compliance if followed.

The ASR-E rack is for indoor installation only. ASR-E is not to be installed in locations where power points will be exposed to water ingress.

### Components for ASR-E Rack used in assembly

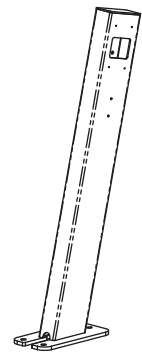

ASR-E Rack (x1)

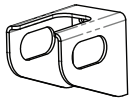

ASR-E Lock Bracket (x1)

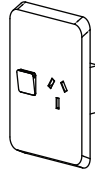

AUS electrical power point with fasteners (actual part supplied may vary) (x1)

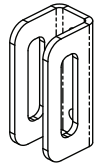

ASR-E Lock Bracket (x1)

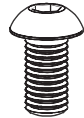

Lock bracket screws and washers M8 (x4)



Cable lock bracket screws and washers M5 (x2)

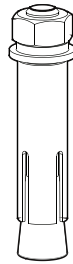

M10 x 80mm anchor bolts with tamper resistant fasteners (X3)



Security shear nuts (X3)

### Conduit Components



M8 Flat metal washer (X2)

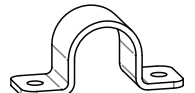

Conduit mounting bracket (X1)



Plastic plug (x2)

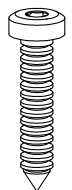

M8 Security Screw (X2)

### 1. Site selection

When selecting a site for your new scooter rack, the most important advice is;

**Do not try to hide it, as it will not be used!**

Suitable locations include;

- Adjacent to entrance doors and in line of sight of a window
- Near high pedestrian traffic
- A flat location at the same surface level which cyclists and scooter riders use for access
- Covered areas

Other things to remember;

- Where a rack is being installed at an existing location, the rack should be placed where bicycles and scooters are currently parked or charged
- When using a garage location, it is recommended to use a parking bay that is nearest to an entrance door.

# Bike Rack Installation Instructions

## Cora Bike Rack - ASR-E Adult eScooter Charging Rack

### 2. Minimum access and clearance dimensions

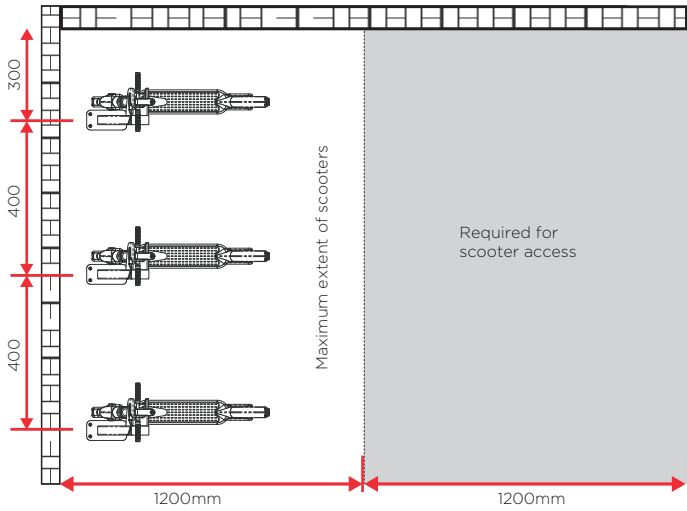

#### Access dimensions around scooter racks

- Before mounting rack, find a suitable place that will allow for minimum spacing dimensions
- Ensure minimum spacing from walls, other racks or obstructions to allow for minimum access

\*See product specification sheets for alternate mounting options. Can be found at [cora.com.au](http://cora.com.au)

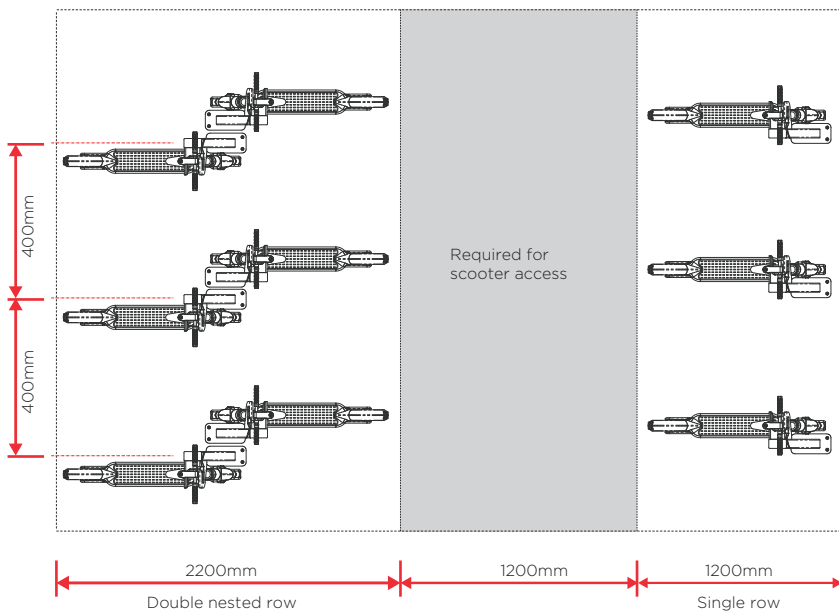
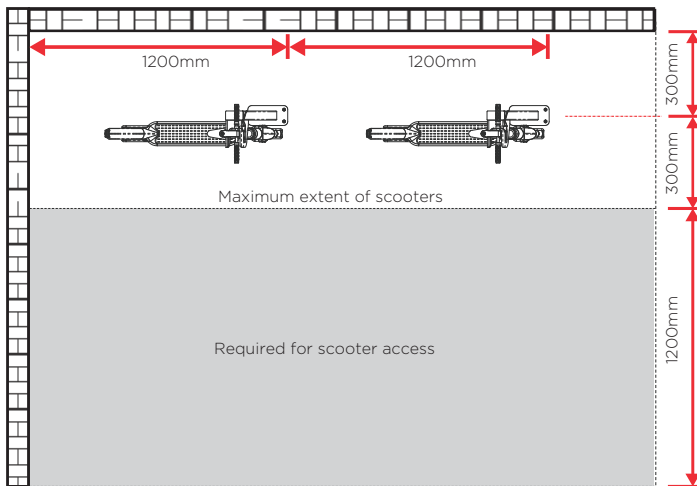

# Bike Rack Installation Instructions

## Cora Bike Rack - ASR-E Adult eScooter Charging Rack

### 3. Electrical layout suggestions and options

*Please refer to warning on first page of instructions before commencing this stage of installation. Layout images provided are suggestions only. Actual cable routing method and electrical connection between racks, should be specified by a qualified electrician.*

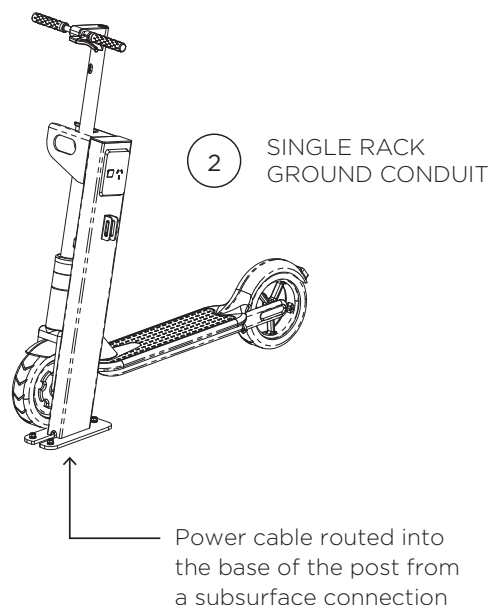
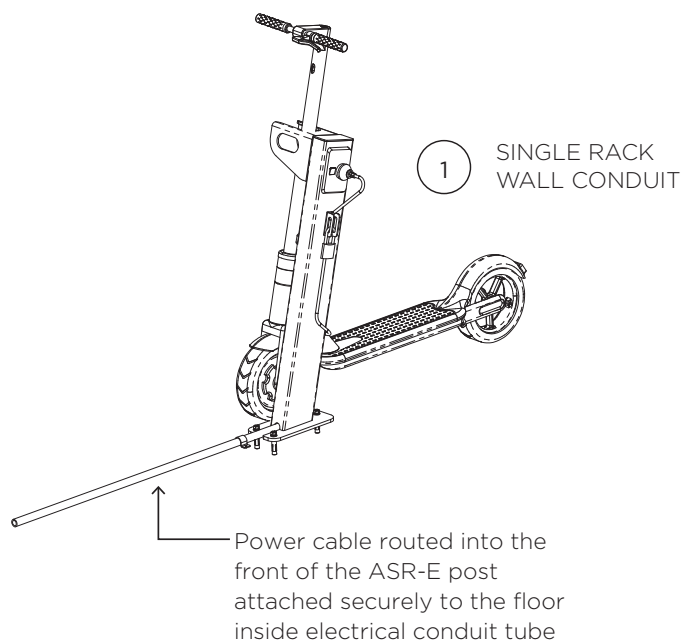

### ROUTING THE POWER CABLE/ INSTALLATION:

- The ASR-E rack is designed for routing of cable for connection to a mains power source.
- Power cable can either be routed directly into the side of ASR-E post (inside electrical conduit tube), or from a subsurface connection directly into the bottom of the rack post
- The post is designed to accept 20mm diameter electrical conduit tubing.

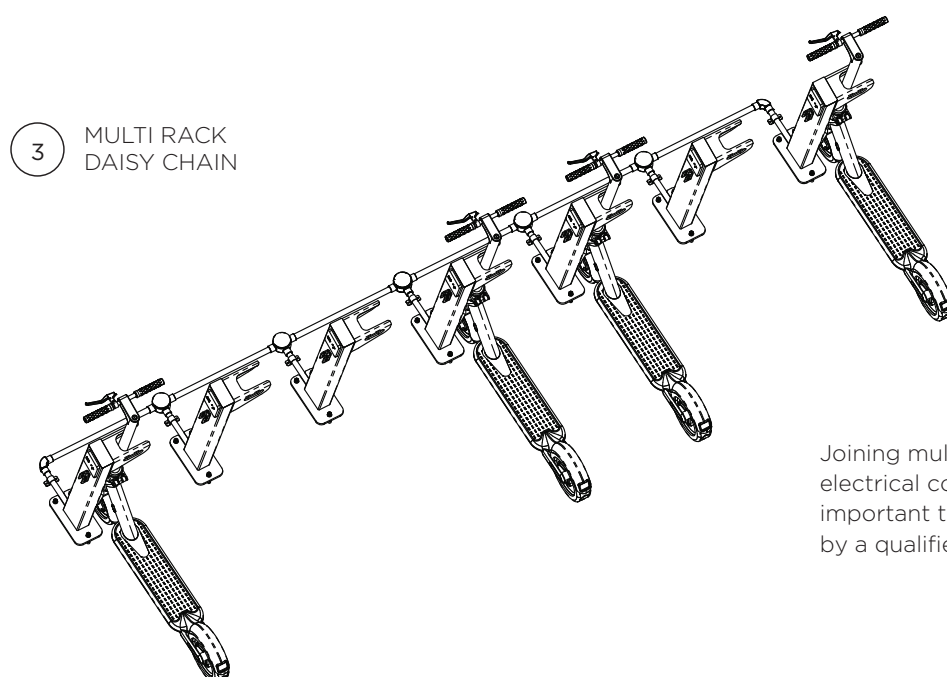

# Bike Rack Installation Instructions

## Cora Bike Rack - ASR-E Adult eScooter Charging Rack

### 4. Installing racks next to a wall

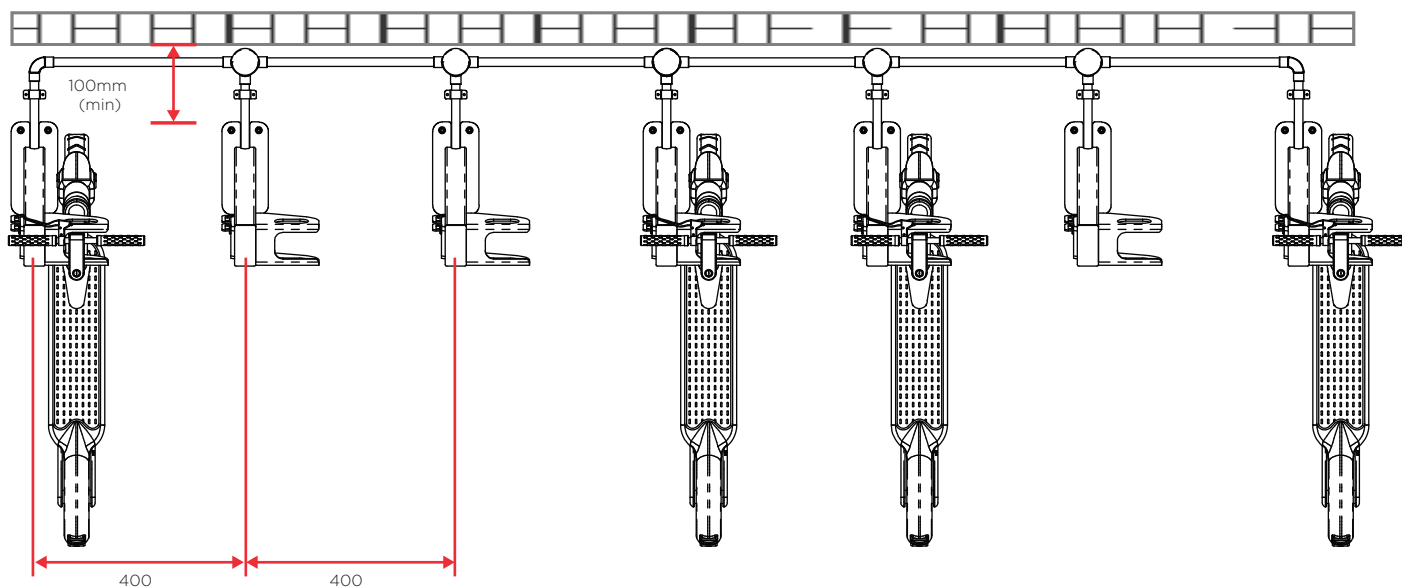

- When installing ASR-E racks next to a wall, any conduit or material used to protect electrical cabling between racks, must be fixed between the rack and the wall, and as close to the wall as possible.
- ASR-E racks are to be fixed at a minimum 100mm from the wall to the front of the mounting plate. 100mm is a minimum dimension dependent on the electrical cabling/ conduit configuration.

### 5. Adding the scooter lock bracket to the post

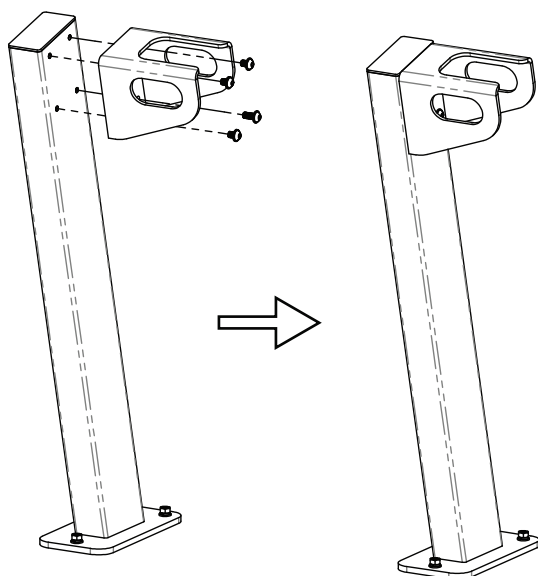

- Lock bracket needs to be fixed to the main post. This can be done either before or after post is fixed to ground (we suggest prior to fixing post to ground may be easier)
- Fix the lock bracket directly to the post using screws supplied
- Ensure a washer is used under the head of each fastener.

## Bike Rack Installation Instructions

### Cora Bike Rack - ASR-E Adult eScooter Charging Rack

---

#### 6. Adding the charging cable lock bracket to post

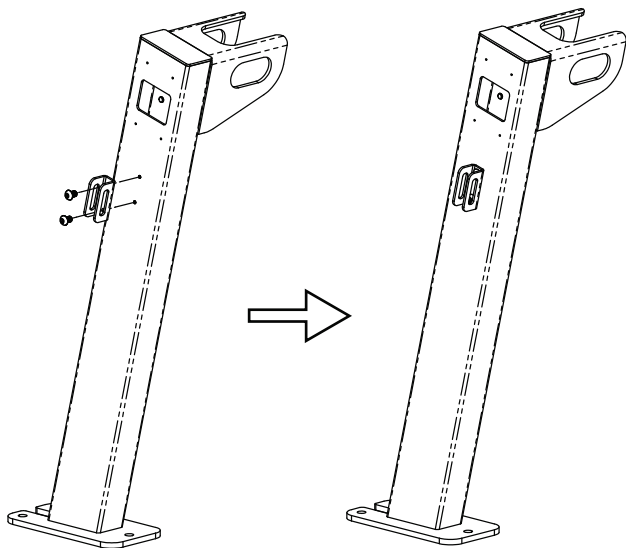

- Charge cable lock bracket to be fixed to the main post
- This can be done either before or after post is fixed to ground using anchor bolts
- Lock bracket part is fixed directly to the post using the 2x M5 screws supplied
- Ensure a washer is used under the head of each fastener.

---

#### 7. ASR-E series mark fixings and conduit route

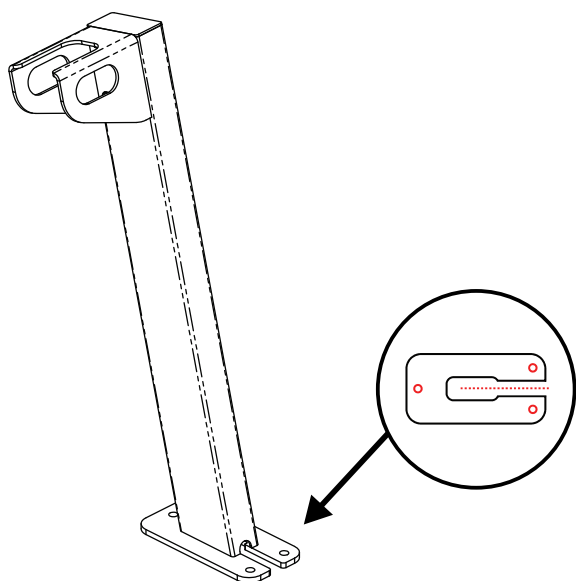

- Place rack in the desired location, ensuring correct clearance on all sides
- Mark all 3 fixing points with a suitable marker.
- Remove rack to side - do not drill through base as this could damage the masonry bit.
- Carefully drill holes using a 10mm masonry drill bit to a depth of 75mm, maintaining correct positioning.
- **Do not drill over plumbing and/or electrical-conduits, or through waterproof membranes that may be located just below surface level.**
- Clear holes of dust and debris.
- Place the ASR-E scooter rack over holes and check correct alignment.

# Bike Rack Installation Instructions

## Cora Bike Rack - ASR-E Adult eScooter Charging Rack

---

### 8. Attach conduit to wall or ground

**Installation suggestion - this step can be completed at the discretion of the installer however electrical wiring of ASR-E may be easier if conduit is already in-place before the rack is fixed to the ground**

- Place conduit in the desired location.
- Carefully drill 10mm holes to a depth of 50mm
- **Do not drill over plumbing and/or electrical-conduits, or through waterproof membranes that may be located just below surface level.**
- Tap in plastic plugs supplied
- Fix conduit mounting bracket with M8 security screws.

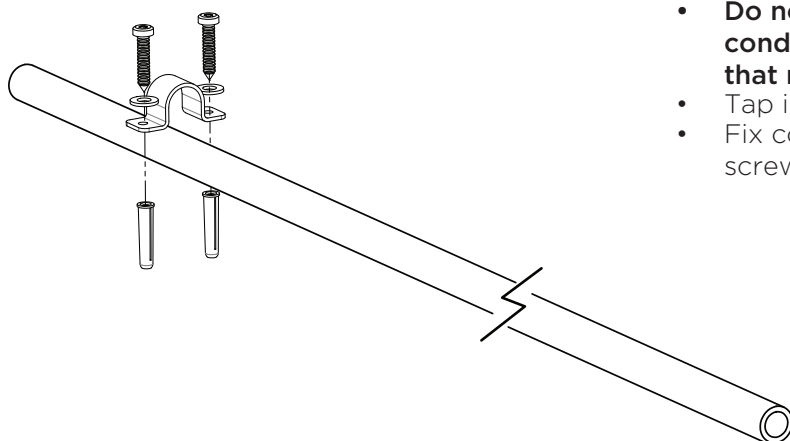

---

### 9. Conduit route and access to rack

**Installation suggestion - before fixing rack**

- Electrical wiring of ASR-E may be easier if conduit is already in-place before the rack is fixed to the ground
- Electrical wires may be inside the conduit already or can be fed through after fixing of the rack to the ground
- Electrical wires will need to exit the conduit inside the rack and be fed to the top of the post to be connected to the power point
- Conduit can be fixed in place, before the rack is fixed with anchor bolts
- Adding a tight elbow or bend to the end of the conduit inside the post, may aid in reducing floor level water ingress into the conduit.

**Note:**

***Please refer to the warning on the first page of these instructions before commencing this stage of the installation***

- If pre routing the power cable through the conduit, allow a minimum cable length to reach the top of post to be connected to the power point.

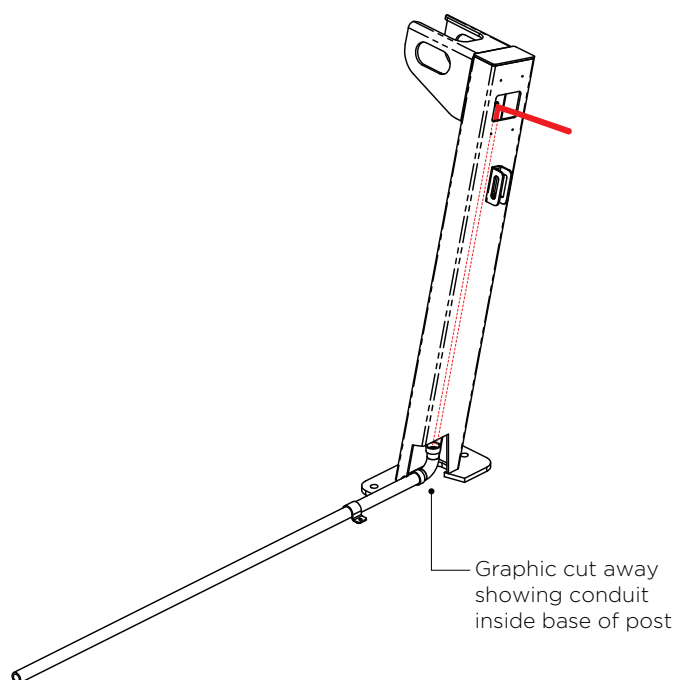

# Bike Rack Installation Instructions

## Cora Bike Rack - ASR-E Adult eScooter Charging Rack

---

### 10. ASR-E series fixings - concrete surfaces

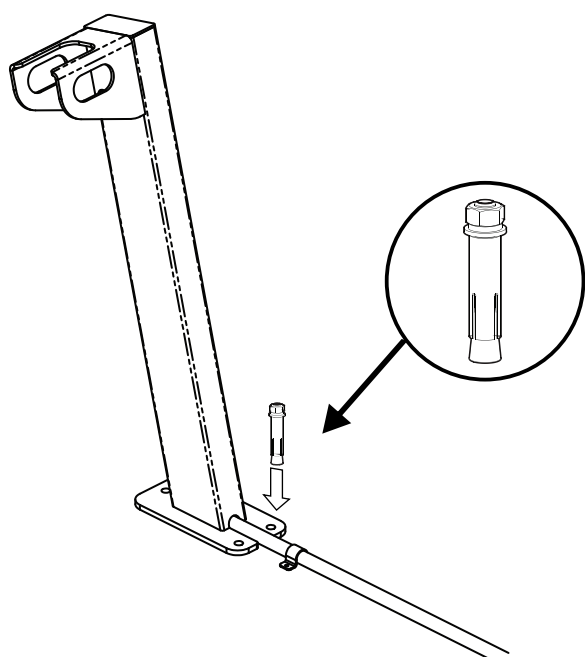

- Use the anchor bolts included
- Place rack in the desired location, ensuring correct clearance on all sides
- Place the ASR-E scooter rack over pre drilled holes and check correct the alignment.
- Use the included (x3) anchor bolts. Loosen the hex nuts to the end of the anchor bolts.
- Place the anchor bolts through the base plate and hammer into the drilled holes until the washers are flush with the base plate of the rail. Tighten hex nuts firmly.

#### Installation suggestion

- Electrical wiring of ASR-E may be easier if conduit is already in-place before rack is fixed to ground
- Electrical wires may be inside the conduit already or fed through after fixing the rack to the ground
- Electrical wires will need to exit the conduit inside the rack and be fed to the top of the post to be connected to the power point.

---

### 11. Adding the security nuts

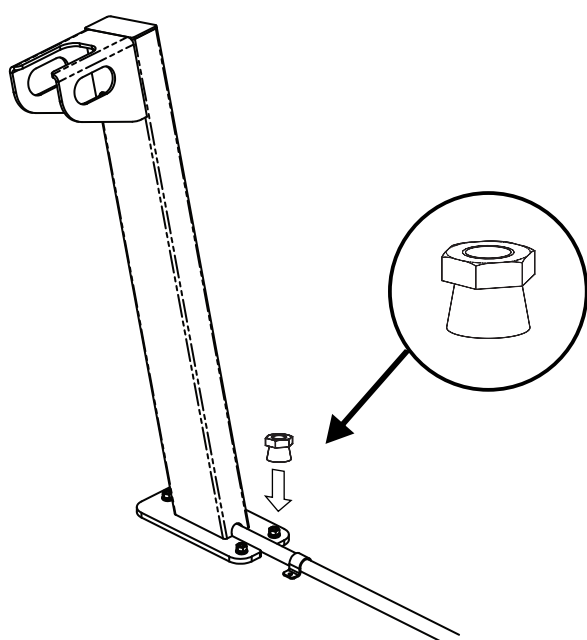

- To use the included security shear head nuts, carefully remove the tightened standard nuts, leaving the flat washers in place
- Screw on the new security nuts with the wide round base at the bottom
- Tighten the security nut firmly, and keep tightening until the top half of the nut snaps off
- Remove the top half of the security nut and discard. The lower half remains in place to provide an effective tamper resistant fixing.

# Bike Rack Installation Instructions

## Cora Bike Rack - ASR-E Adult eScooter Charging Rack

### 12. Power point installation

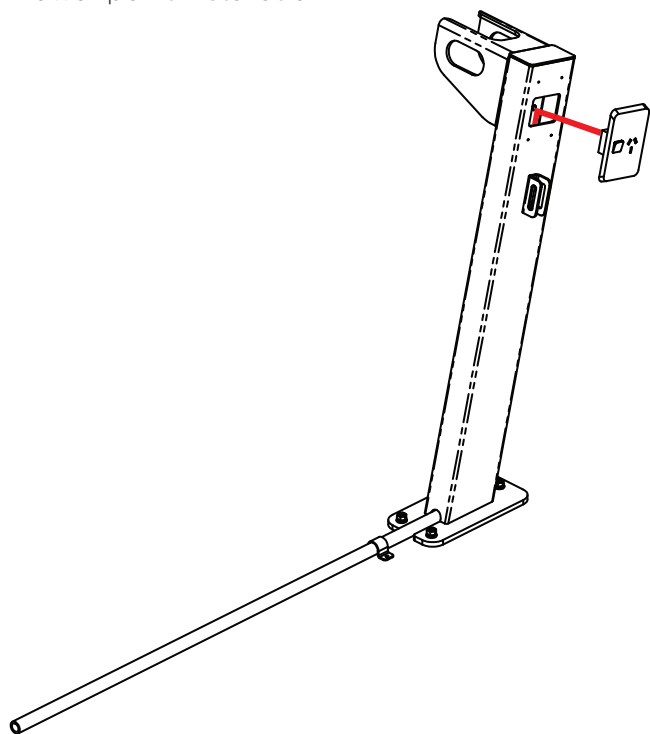

*Please refer to warning on first page of these instructions before commencing this stage of the installation*

- Electrical cable to be brought to the top of the post and out of the power point access hole
- Power cable to be fixed to the power point

### 13. Installation complete

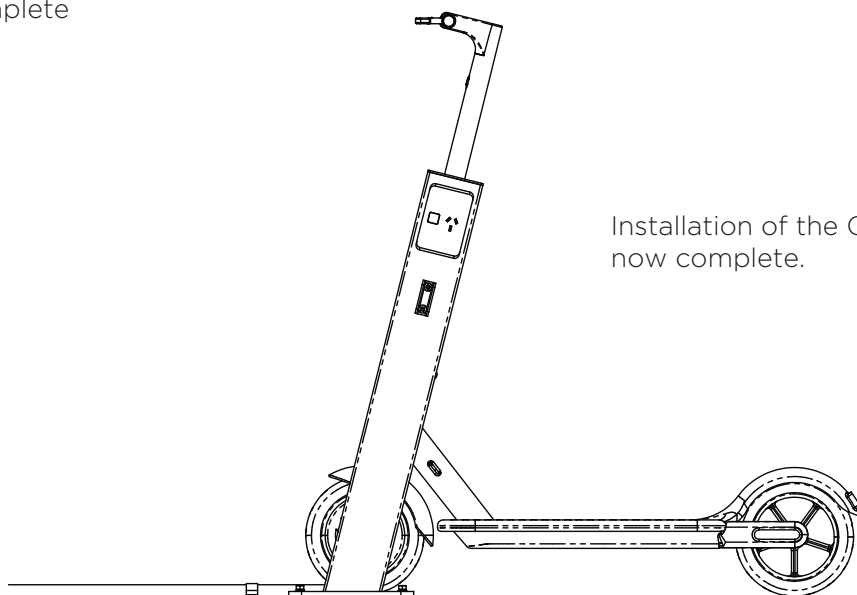

Installation of the Cora ASR-E rack is now complete.



**CORA**  
BIKERACK

PH 1800 249 878

[sales@cora.com.au](mailto:sales@cora.com.au)

[www.cora.com.au](http://www.cora.com.au)